

A network diagram background with nodes and connections. The nodes are represented by concentric circles in shades of green and yellow, connected by thin lines. The overall color scheme is dark green and black.

# TRANSPORT IN A NETWORKED SOCIETY

**NECTAR XIV**  
**International Conference**

**31 May – 2 June 2017**  
**Madrid, Spain**

NECTAR website: <http://www.nectar-eu.eu/>  
Conference website: <http://eventos.ucm.es/go/nectar2017conference>  
Follow us on Instagram and Twitter: @2017Nectar | #2017NectarConference

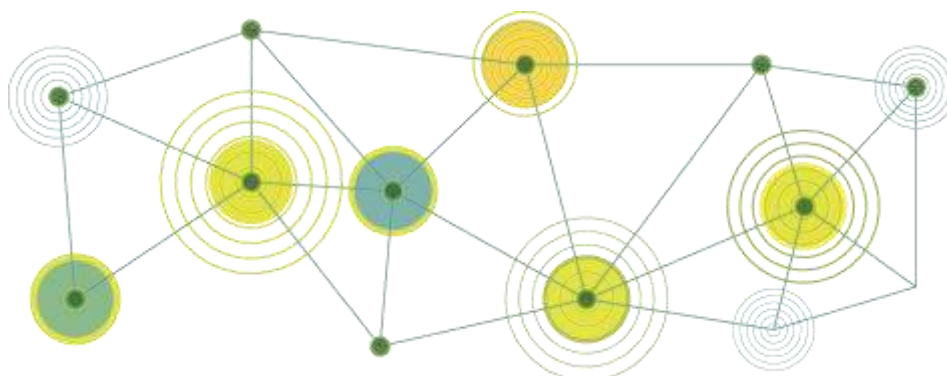

## NECTAR XIV International Conference

May 31<sup>st</sup> – June 2<sup>nd</sup>, 2017. Madrid, Spain

	WEDNESDAY 31/05	THURSDAY 01/06	FRIDAY 02/06
9:00 – 11:00		Parallel Sessions (CL3; CL4; CL5; G4; G5; G6)	Parallel Sessions (CL5; CL6; G13; G14; G15; G16)
11:00-11:30		Coffee Break	Coffee Break
11:30-12:30		<b>Transport in a Networked Society: The way ahead</b>	<b>Transfer transport innovations into business</b>
12:30-13:30		Lunch	Lunch
13:30-14:30	<b>OPENING SESSION</b> (14:00-14:30)	Parallel Sessions (CL6; CL8; CL1; G7; G8; G9)	Parallel Sessions (G17; G18; G19)
14:30-15:30	<b>Keynote speaker</b> Prof. Banister - <i>Un. of Oxford</i>		PhD award ceremony, Cluster words and closing session
15:30-16:00	Coffee Break	Coffee Break	
16:00-18:00	Parallel Sessions (CL1; CL2; CL8; G1; G2; G3)	Parallel Sessions (CL2; CL3; CL4; G10; G11; G12)	Technical visit M30 and Madrid Rio
18:00-19:00	<b>Cluster meeting</b> (CL1; CL2; CL6; CL7)	<b>Cluster meeting</b> (CL3; CL4; CL5; CL8)	
19:00-20:00	Welcome reception		
20:00 – 00:30		NECTAR 25 years birthday dinner	

### Registration desk working hours:

Wednesday May 31<sup>st</sup> 11:00 – 17:00

Thursday June 1<sup>nd</sup> 08:30 – 13:30

Friday June 2<sup>nd</sup> 08:30 – 13:30

## Venue



**Escuela de Ingenieros de Caminos, Canales y Puertos**  
**Universidad Politécnica de Madrid**  
**Campus Ciudad Universitaria**

## Organizing Committee

### International Committee



*NECTAR Chair*  
Karst Geurs



*NECTAR Secretariat*  
Ana Condeço



*EU JRC*  
Panayotis Christidis

### Local Committee



*Co-Chair*  
Andrés Monzón  
TRANSyT Director  
UPM



*Co-Chair*  
Javier Gutiérrez  
tGIS Director  
UCM



*Secretariat*  
Ana Condeço  
tGIS  
UCM



*Secretariat*  
Iria López



*Administrator*  
Carmen Pérez  
TRANSyT  
UPM



*Communication*  
Patricia Rico  
TRANSyT  
UPM

# WEDNESDAY 31<sup>st</sup> MAY

<b>14.00-14.30</b>	<b>Opening Session- Welcome messages</b>	
<b>Conference Room</b>	<b>Prof. Andrés Monzón</b> , LOC, UPM <b>Prof. Francisco Martín</b> , Director of the School of Civil Engineering, UPM <b>Prof. Karst Geurs</b> , NECTAR Chair, Univ. Twente	
<b>14.30-15.30</b>	<b>Keynote Presentation</b>	
<b>Conference Room</b>	Chair: <b>Franciso de Paula Coelho</b> , EIB Institute  <b>Prof. David Banister</b> University of Oxford	
<b>15.30-16.00</b>	<b>Coffee break</b>	
		
<b>16.00-18.00</b>	<b>Parallel Sessions</b>	
<b>Seminars Room</b>	<b>CL1. Transport Infrastructure Impacts and Evaluation</b> (Chair: Robin Hickman)	
	Motility and Wellbeing: A Study Methodology	Moshe Givoni, Rebecca Shlisselberg
	The condition of working women in the urban periphery: socio-spatial inequalities and mobility in Istanbul	Eda Beyazit, Ceyda Sungur
	Social equity for transport infrastructure project assessment: A case study on accessibility of healthcare services in Metro Manila, Philippines	Neil Stephen Lopez, Robin Hickman, Tim Schwanen, Jose Bienvenido, Manuel Biona
	Social equity in low and high income neighbourhoods in Manila	Robin Hickman
<b>Conference Room</b>	<b>CL2. Policy and Environment</b> (Chair: Wafa Elias)	
	The study of the environmental impact of transport based on socioeconomic characteristics: an application of CHAID algorithm	Flora M <sup>a</sup> Díaz-Pérez, Maria Bethencourt-Cejas
	Preferences for sustainable mobility in natural areas: The case of Teide National Park.	Concepción Román, Rosa Marina González
	Uncertainty in the Economic Valuation of Climate Change and Consequences for Transport Policy	Silvio Nocera, Federico Cavallaro
<b>Room 42</b>	<b>CL8. Information and Communication Technologies</b> (Chair: Luc Wismans)	
	Strategies for the seamless deployment of travel diary collection systems to new regions	Adrian C. Prelipcean, Yusak O. Susilo
	Automated personal trip identification app for mobility data collection in Malta	Maria Attard, Michael Camilleri, Adrian Muscat, Victor Buttigieg
	Collection of trip data using a semi-automated, user-mediated mobile application	Ulrik Berggren, Carl Johnsson, Helena Svensson, Anders Wretstrand







# WEDNESDAY 31<sup>st</sup> MAY

16.00-18.00		Parallel Sessions (cont.)	
Room 30	<b>G1. Accessibility &amp; equity issues</b> (Chair: Ana Isabel Moreno)		
	Assessing spatial equity impacts: ex-post evaluation of cipularang toll road construction	I Gusti Ayu Andani, Lissy La Paix, Karst Geurs	
	Exploring the links between public transport accessibility, social exclusion and social diversity in a rapidly changing transport system: The case of Medellin, Colombia	Ana I. Moreno, Daniel Oviedo, Gustavo García	
	Bridging the gap: The impacts of changes in accessibility levels on closing the socioeconomic gap in Toronto, Canada	Genevieve Boisjoly, Ahmed El-Geneidy, Emily Grise	
Room 31	<b>G2. Socio-economic impacts of transport infrastructure</b> (Chair: Yang Wang)		
	HRS commuting impacts on labour migration: the case of the Spanish regions connected to the big metropolitan areas	Begoña Guirao, Antonio Lara	
	Is there any relationship between the accessibility improvement and regional development?	Bartłomiej Rokicki, Marcin Stępniaak	
	Urban transport investments and local regeneration: the social impacts of the Copenhagen Metro on intra-urban development	Kristian Bothe, Christine Benna Skytt-Larsen	
	Analysing the impact of ICT measures on the fuel consumption of light-duty vehicles on the road network	Fiamma Perez-Prada, Yang Wang, Andrés Monzón	
Room 32	<b>G3. Cycling infrastructure</b> (Chair: Isabelle Thomas)		
	Is the use of a bicycle-sharing system influenced by travel patterns, users' perceptions and technological characteristics? A structural equation modelling approach	Andres Garcia-Martinez, Guillermo Velazquez, Andrés Monzón	
	An environmental quality assessment of the cycling infrastructure in Amsterdam	Julia Úbeda, Jurg Wilbrink, Falco Joosten	
	Cyclists do better. Analysing urban cycling operating speeds, accessibility and performance	Gustavo Romanillos, Javier Gutiérrez	
	Comparing 75 Bicycle Sharing Systems: a critical appraisal	Isabelle Thomas, Cyrille Médard de Chardon, Geoffrey Caruso	
18.00-19.00		Cluster meetings	
Room 42	<b>Cluster 1: Transport Infrastructure Impacts and Evaluation</b> (Chair: Moshe Givoni, Bart Jourquin, Robin Hickman)		
Room 30	<b>Cluster 2: Policy and Environment</b> (Chair: María Attard, Edoardo Marcucci, Wafa Elias)		
Room 31	<b>Cluster 6: Accessibility</b> (Chair: Aura Reggiani, Juan Carlos Matín)		
Room 32	<b>Cluster 7: Social &amp; Health Issues</b> (Chair: Karen Lucas, Dick Ettema)		
19.00-20.00		Welcome Reception	

# THURSDAY 1<sup>st</sup> JUNE

9.00-11.00		Parallel Sessions	
Conference Room	<b>CL3. Logistics and Freight</b> (chair: Cathy Macharis)		
	Synchronization of freight shipments in the sharing economy	Joren Gijsbrechts, Robert Boute	
	Capacity-sharing in logistics solutions: one way towards sustainability	Sandra Melo, Joaquim Macedo, Patricia Baptista	
	Integration of freight and passenger transport through crowdshipping in the sharing mobility era	Edoardo Marcucci, Valerio Gatta, Eleonora Pieralice, Michela Le Pira	
	Addressing fragmented last mile deliveries: Increasing load factors by utilizing free transportation capacity	Bram Kin, Sara Verlinde, Cathy Macharis	
Seminars Room	<b>CL4. Commuting, Migration and Labour Market</b> (chair: Anette Haas)		
	Does new information technology change commuting behavior?	Thomas de Graaff	
	Modelling commuting flows via fixed components	Inge Thorsen, Sahar Babri, Kurt Jörnsten, Jan Ubøe	
	Soft factors, interurban structure and commuting patterns in Poland	Szymon Marcińczak	
	Effect of Urban Land Use on Travel Behavior in Developing Countries: Evidence from Pakistan	Edmund Zolnik, Ammar Malik, Omar Riaz	
Room 42	<b>CL5. Leisure, Recreation and Tourism</b> (chair: João Romão)		
	Modelling cruise lines' duration of stay in ports: Evidence from Japan	Peter Nijkamp, Jamie M. Chen	
	Heterogeneities in modal split between home and tourist destinations: A Survey of young Milan young residents	Ila Maltese, Luca Zamparini	
	Tourism and leisure vehicle driver's behaviors of stopover at SA/PAS on expressway: Market segmentation and the location choice modeling	Kazuo Nishii, Kuniaki Sasaki, Shun-ichi Yoshihara, Jun Tanabe	
	Forecasting Wellness Tourism Development in Hokkaido	João Romão, Kazuo Machino, Peter Nijkamp	
Room 30	<b>G4. Mobility &amp; labour markets</b> (chair: Mario Aymerich, EIB)		
	Job Accessibility in the Netherlands: Can the right people access the right jobs?	John P Pritchard, Karst Geurs, Marcin Stepniak	
	Effects of workplace locations and workers' attributes on commuting behavior in the Munich Metropolitan Region	Julia Kinigadner, Gebhard Wulfhorst, Benjamin Buettner	
	Co-Dependent Workplace, Residence and Commuting Mode Choice: Analysis of a Multi-Dimensional Pivoted Stated Choice Experiment	Jia Guo, Tao Feng, Harry Timmermans	
	Measuring transnational population mobility with roaming data	Rein Ahas	
Room 31	<b>G5. Cycling and transport sustainable options</b> (chair: Sigal Kaplan)		
	Substitutability as a concept to understand travel behaviour	Bert van Wee, Sander van Cranenburgh	
	Promoting cycling for commuting: a longitudinal study of attitudes change	David Lois, Andrés Monzón, Juan Antonio Moriano	
	Characterization of behaviours of young electric bicycle riders in Israel, to promote sustainable urban transportation	Wafa Elias, Victoria Gitelman	
	The role of existence, relatedness and growth in adapting from a car-oriented to a cycling-oriented culture	Sigal Kaplan, Dagmara Wrzesinska, Carlo G. Prato, Otto A. Nielsen	

# THURSDAY 1<sup>st</sup> JUNE

<b>9.00-11.00</b>		<b>Parallel Sessions (cont.)</b>			
<b>Room 32</b>	<b>G6. Equity &amp; social issues</b> (chair: Karen Lucas)				
	Assessing Daily Urban systems in Belgium: a network approach based on commuting flows, with special attention to gender and income differences.	Ann Verhetsel, Michiel De Meyere, Joris Beckers			
	Role or Gender? Analysis of activity participation in Canadian households with a focus on single parents	Antonio Paez			
	The role of geographic and fear-based exclusion on mode choice: the case-study of young Palestinians in East Jerusalem	Tamara Kerzhner, Murad Natesh, Sigal Kaplan, Emily Silverman			
	A mixed-methods approach for the social assessment of transport infrastructure projects	Karen Lucas, Ian Philips, John Nellthorp, Louise Reardon, James Laird, Ersilia			
<b>11.00-11.30</b>		<b>Coffee break</b>			
					
<b>11.30-12.30</b>		<b>Round table "Transport in a Networked Society: The way ahead"</b> (NECTAR founders/ Chair: Cathy Macharis)			
<b>Conference Room</b>					
	<b>Prof. Peter Nijkamp</b>	<b>Prof. Michael Wegener</b>	<b>Prof. Aura Reggiani</b>	<b>Prof. Marina van Geenhuizen</b>	<b>Prof. David Banister</b>
	Vrije Universiteit Amsterdam	S & W	University of Bologna	TU Delft	University of Oxford
<b>12.30-13.30</b>		<b>Lunch</b>			
					
<b>13.30-15.30</b>		<b>Parallel Sessions</b>			
<b>Conference Room</b>	<b>CL6. Accessibility</b> (chair: Aura Reggiani)				
	Accessibility and socio-economic development in Mexico's "Montaña de Guerrero" region: A critical evaluation	Jessica Villena, Jean-Claude Thill, Luis Chias			
	Territorial cohesion, equity and accessibility to public services in Poland	Marcin Stepniak			
	Road accessibility in border regions	Ana Condeço-Melhorado, Panayotis Christidis			
	Resilience and accessibility of Swedish and Dutch municipalities	Aura Reggiani, John Östh, Peter Nijkamp			

# THURSDAY 1<sup>st</sup> JUNE

13.30-15.30		Parallel Sessions (cont.)	
Room 42	<b>CL8. Information and Communication Technologies</b> (chair: Rein Ahas)		
	Can the mobility of phones be used to depict the spatial organization of regions?	John Östh, Aura Reggiani, Lauri Shintler	
	Measuring urban complexity in Brussels: communities, clusters and urban transportation issues	Arnaud Adam, Isabelle Thomas	
	The pulse of the city through twitter: relationships between land use and spatiotemporal demographics	Borja Moya-Gómez, María H. Salas-Olmedo, Ana Condeço-Melhorado, Javier Gutiérrez	
	Comparison of interpolation techniques for state estimation on urban networks	Luc Wismans, Luuk de Vries, Eric van Berkum	
Seminars Room	<b>CL1. Transport Infrastructure Impacts and Evaluation</b> (chair: Bart Jourquin)		
	Transport Investment and Social Justice in Beijing	Mengqiu Cao, Robin Hickman	
	Identifying the Impact of Transport Connectivity on Housing Prices in London: A Hedonic Analysis of London Transport Links	Imogen Thompson	
	City rights, mobility needs: a new approach for transport policy evaluation	Floriea di Ciommo	
	Measuring Central Human Capabilities in Transport as a complementary method for appraising transport projects in the context of Santiago de Chile.	Beatriz Mella	
Room 30	<b>G7. Intermodal freight</b> (chair: Tom van Lier)		
	Intermodal transport: does a wider definition improve its competitiveness?	Martine Mostert, An Caris, Sabine Limbourg	
	Time and intermodality in Liner Ship Fleet Deployment. A quadratic programming model applied to the Far East – USA trade flows	Manuel Herrera, Per J. Agrell, Casiano Manrique, Lourdes Trujillo	
	Benefits of a shared trailer parking concept for companies and society in practice: the Antwerp case	Tom van Lier, Cathy Macharis, Johan Boonen	
Room 31	<b>G8. ICT &amp; travel behaviour</b> (chair: João de Abreu)		
	User's factors influencing the adoption of a public transport mobile app, an approach through SEM	Guillermo Velazquez, Andrés Monzón	
	Multitasking on the go: an observation study on public transport in Brussels	Imre Keseru, Cathy Macharis	
	Measuring the effects of teleworking over the land use and transport systems in Madrid Region	Andrea Alonso, Yang Wang, Andrés Monzón	
	Measuring the influence of social media and instant messaging usage on weekday and weekend face-to-face social activities	João de Abreu, Juan de Oña, Slaven Gasparovic	
Room 32	<b>G9. New mobility options</b> (chair: Francesc Soriguera)		
	Subsidies for private consumers buying electric cars	Hans Nijland, Gerben Geilenkirchen, Jordy van Meerkerk	
	Electric vehicle rental and EV-adoption	Joram Langbroek, Joel Franklin, Yusak Susilo	
	Going towards a shared mobility: the role of time perception and the loyalty to the car	Sara Ahetze Puignau, Floridea Di Ciommo	
	Optimization of the strategical design in a one-way car sharing system	Francesc Soriguera, Enrique Jiménez	
15.30-16.00		Coffee break	
			



# THURSDAY 1<sup>st</sup> JUNE

16.00-18.00		Parallel Sessions	
Conference Room	<b>CL2. Policy and Environment</b> (chair: Edoardo Marcucci)		
	Circular economy, environment protection and innovative freight transport solutions: the case of Rome living lab	Valerio Gatta, Edoardo Marcucci, Michela Le Pira	
	Driving behavior patterns: impacts in emissions and safety performance	Marta Faria, Tiago Farias, Patricia Baptista	
	Urban toll and electric vehicles: the winning ticket for European Cities!	Stéphanie Souche-Le Corvec, Aurélie Mercier, Nicolas Ovtracht, Amandine Chevallier	
	The transition to zero-emission buses in public transport: the role of the institutional setting	Rob Konings, Sjoerd Bakker	
Room 42	<b>CL3. Smart logistics</b> (chair: Sandra Melo)		
	Smart governance in construction logistics: how to include participation in decision making?	Philippine de Radiguès, Cathy Macharis, Tom van Lier	
	Bringing real-time simulation closer to reality: The next frontier of modelling synchromodal transport	Dries Meers, Tomas Ambra, Cathy Macharis, An Caris	
	Revisiting the vehicle routing problem. Towards new approaches for urban logistics within smart cities.	Pablo Álvarez, Adrián Serrano, Jesús M. Pintor, Javier Faulin	
	Revenue Management for Smart City Logistics	Luis Cadarso, Adrián Serrano, Javier Faulin	
Seminars Room	<b>CL4. Commuting, Migration and Labour Market</b> (chair: Liv Osland)		
	Regional distribution and location choices of immigrants in Germany	Tanis Kerstin	
	Displacement and Job Search in Thick Labor Markets: Evidence from Plant Closures	Peter Haller, Daniel F. Heuermann	
	A stated preference experiment into the trade-off between residential location, accessibility and commuting	Ori Rubin, Femke Daalhuizen, Frank van Dam	
	Valuation of segregated residential settlement patterns in an urban housing market	Liv Osland, Viggo Nordvik, Inge Thorsen, Ingrid S. Thorsen	
Room 30	<b>G10. Accessibility planning</b> (chair: Cecília Silva)		
	Geographic Information System Based Accessibility and connectivity Analysis for Highway Transportation in Istanbul, Turkey	Hande Demirel, Merve Korkutan, Wasim Shoman	
	A methodology to evaluate urban fragmentation and superblocks implementation. Case study Vitoria-Gasteiz	Javier Delso, Emilio Ortega, Belén Martín	
	Access to basic service areas and facilities in Europe	Mert Kompil, Chris Jacobs-Crisioni, Lewis Dijkstra, Carlo Lavallo	
	Challenges for Accessibility Planning and Research in the context of Sustainable Mobility	Cecília Silva	
Room 31	<b>G11. Freight &amp; ports</b> (chair: Marina van Geenhuizen)		
	Port-centric cities? The role of freight distribution in defining the port-city relationship	Jason Monios, Rickard Bergqvist, Johan Woxenius	
	Port Initiated Incentives and Fees for more Sustainable Transport -an Hinterland Perspective	Rickard Bergqvist, Marta Gonzalez	
	A study on port efficiency in the Caribbean and Macaronesian islands	Luís Machado, António Pais	
	Seaports and accelerating energy transition: Rotterdam and other European seaports	Marina van Geenhuizen	



# THURSDAY 1<sup>st</sup> JUNE

<b>16.00-18.00</b>		<b>Parallel Sessions (cont.)</b>	
<b>Room 32</b>	<b>G12. Big data for transport</b> (chair: Marina Toger)		
	Integrating nighttime light data and color composite bands from satellite imagery into transport modelling	Hector G. López-Ruiz	
	Monitoring traffic flow with mobile phones and validation of call detail records: A comparison of traffic counts and call detail records	Fredrik A. Gregersen, Christian Weber, Rikke Ingebrigtsen	
	Exploring the potential of Big Data for accessibility assessments: a case study for the Madrid Metropolitan Area	Pedro García-Albertos, Miguel Picornell, Javier Gutiérrez, María H. Salas-Olmedo	
	Digital traces of urban flows: cell phone data census of mobility in Stockholm area	Marina Toger, John Östh	
<b>18.00-19.00</b>		<b>Cluster meetings</b>	
<b>Room 30</b>	<b>Cluster 3: Logistics and Freight</b> (Chair: Cathy Macharis, Sandra Melo)		
<b>Room 31</b>	<b>Cluster 4: Commuting, Migration and Labour Market</b> (Chair: Liv Osland, Anette Haas)		
<b>Room 32</b>	<b>Cluster 5: Leisure, Recreation and Tourism</b> (Chair: Peter Nijkamp, Luca Zamparini, João Romão)		
<b>Room 42</b>	<b>Cluster 8: Information and Communication Technologies</b> (Chair: Rein Ahas, Luc Wismans)		
<b>20.30</b>		<b>DINNER</b>	
<p><b>NECTAR 25 years anniversary dinner</b>            Colegio de Ingenieros de Caminos            Calle Almagro, 42            28010 Madrid</p>			
		<b>Metro stations:</b> Rubén Darío (line 5)/ Alonso Martínez (lines 4, 5 and 10)	

# FRIDAY 2<sup>nd</sup> JUNE

9.00-11.00		Parallel Sessions	
Room 42	<b>CL5. Leisure, Recreation and Tourism</b> (chair: Luca Zamparini)		
	What makes places being likely visited and how this relates to one's multiday travel patterns?	Yusak O. Susilo, Wen Zhang, Nursitihazlin A. Termida	
	Transport and tourism: is it a matter of accessibility?	Paolo Beria, Ila Maltese	
	Measuring Tourist Walkability with the WalkScore <sup>TM</sup> index	Yael Ram, C. Michael Hall	
	The Economic Value of Leisure Time: a theoretical and empirical review	Luca Zamparini, Ila Maltese	
Conference Room	<b>CL6. Accessibility</b> (chair: Karst Geurs)		
	Accessibility to health facilities in São Paulo – assessing the impact of the monorail line 15	Thiago Guimaraes, Jeroen Bastiaanssen	
	The impacts of spatial aggregation on accessibility measurement in transport modelling	Ouassim Manout, Patrick Bonnel, Hakim Ouaras	
	Daily variation in transit accessibility to health care services. A case study in Madrid, Spain	Gennaro Angiello, María H. Salas-Olmedo	
A comparison of Job Accessibility in Sao Paulo and the Randstad	Karst Geurs, John P Pritchard, Borja Moya-Gómez		
Room 30	<b>G13. Infrastructure planning &amp; evaluation</b> (chair: Anthony Perl)		
	Evaluating user-centered mobility scenarios: The Mobility4EU approach	Cathy Macharis, Imre Keseru, Thierry Coosemans	
	Assessing the impacts of transport backcasting scenarios in Andalusia (Spain) through the use of multi-criteria analysis	Julio A. Soria-Lara, David Banister	
	Does EU support enhance the economic performance of PPP projects? A panel data analysis of road PPP projects in Spain	Laura Garrido, Thais Rangel, María A. Baeza, José Vassallo	
Constructing and deconstructing the transport infrastructure policy paradigm	Anthony Perl, Moshe Givoni		
Room 31	<b>G14. Evaluation of pricing policies</b> (chair: Svein Braathen)		
	How toll paying affects your travel time estimation	Einat Tenenboim, Nira Munichor, Yoram Shifan	
	The impact of non-linearities in income and taste heterogeneity on welfare measures; a real case study	Javier Bas Vicente, Cinzia Cirillo	
Funding of transport networks – the trade-off between cost of public funds and road tolls	Svein Braathen, Morten Welde		
Room 32	<b>G15. Travel behaviour</b> (chair: Marie-Jose Olde)		
	How does travel satisfaction sum up? Decomposing the door-to-door experience for multimodal trips	Roberto F. Abenoza, Oded Cats, Yusak Susilo	
	Multimodality and Activity Participation: a case study in Beijing	Zidan Mao, Dick Ettema	
	Estimating the impacts on the road network of trips made by migrants visiting their country of origin – a case study regarding North African immigrants in Europe	Aris Christodoulou, Panayotis Cristidis	
Life-events and travel behaviour – A Cross-Lagged Panel Analysis using data from the first three waves of the Mobility Panel Netherlands	Marie J Olde, Jaco Berveling, Lucas Harms, Karst Geurs, Lissy La Paix		
Seminars Room	<b>G16. Accessibility &amp; urban mobility</b> (chair: María Henar Salas-Olmedo)		
	A new approach to measure how equitable is accessibility through public transport: considering the impact of the urban environment and the level of service	Ignacio Tiznado-Aitken, Juan Carlos Muñoz, Ricardo Hurtubia	
	Access and egress times influence in high-speed rail trips: a dynamic accessibility analysis	Amparo Moyano, María H. Salas Olmedo, Borja Moya-Gómez, Javier Gutiérrez	
	Modelling access and egress mode choice to train stations using multilevel hierarchical mixed logit models	Lissy La Paix, Karst Geurs	
Who is using the public space? Flow map visualization from twitter data	María H. Salas, Carolina Rojas		

# FRIDAY 2<sup>nd</sup> JUNE

<b>11.00-11.30</b>		<b>Coffee break</b>	
			
<b>11.30-12.30</b>	<b>Round table "Transfer transport innovations into business and institutions"</b> (chair: Stephane Petti- EIB/ Rapporteur: Juan Gómez)		
<b>Conference Room</b>	<b>Carlos Acha</b> , ALSA <b>Ricardo Herranz</b> , Nommon <b>Tomás Melero</b> , CRTM	<b>Mauro Gil</b> , INDRA <b>Ian Paterson</b> , Respiro <b>Gabriel Cuervo</b> , Ferrovial	
<b>12.30-13.30</b>		<b>Lunch</b>	
			
<b>13.30-14.30</b>	<b>Parallel Sessions</b>		
<b>Room 30</b>	<b>G17. Rail Freight</b> (chair: Bart Jourquin)		
	Enhancing the logistics of light goods in rural areas introducing mixed freight and passengers rail services	Victoria Muerza, Emilio Larrodé, Javier Calvo	
	Estimation of travel time elasticities with a multimodal freight transport model based on publicly available regional data	Jourquin Bart	
<b>Room 31</b>	<b>G18. Freight modelling</b> (chair: Cécile Sillig)		
	Exploring stakeholder preferences and acceptability of urban freight transport policy via an agent-based/discrete choice hybrid modelling approach	Michela Le Pira, Edoardo Marcucci, Valerio Gatta, Giuseppe Inturri, Matteo Ignaccolo, Alessandro Pluchino	
	The locational behavior of advanced logistics. A European city network analysis	Cécile Sillig, Mina Akhavan, Hilda Ghiara, Ilaria Mariotti	
<b>Room 42</b>	<b>G19. Potential and criticality of transport infrastructure</b> (chair: Juan Carlos Martin)		
	Analysis, modelling, and assessing prospective role of the trans-European intermodal transport system: the potential of freight transport corridors	Bart Wiegmans, Milan Janic	
	Lessons from the criticality of the Spanish high capacity road network on direct and representative democracies	Juan C. Martin, Javier Gutiérrez, Borja Moya-Gómez	
<b>14.30-15.30</b>	<b>PhD award ceremony, Cluster words and closing Session</b> (chair: Karst Geurs)		
<b>Conference Room</b>	<b>Cyrille Médard de Chardon - PhD award winner</b> <b>NECTAR Chairs and Conference organizers</b>		
<b>TECHNICAL VISIT</b>			
<b>16.30</b>	<b>Madrid Río and M30 orbital motorway projects</b>		

# NECTAR XIV International Conference

May 31<sup>st</sup> – June 2<sup>nd</sup>, 2017. Madrid, Spain

## Rooms

Escuela de Ingenieros de Caminos, Canales y Puertos

Universidad Politécnica de Madrid

Campus Ciudad Universitaria; Calle Profesor Aranguren; 28040, Madrid

1 <sup>ST</sup> FLOOR			
<b>SR</b>	Seminars Room	<b>CR</b>	Conference Room
<b>30</b>	Room 30	<b>31</b>	Room 31
<b>32</b>	Room 32	<b>42</b>	Room 42

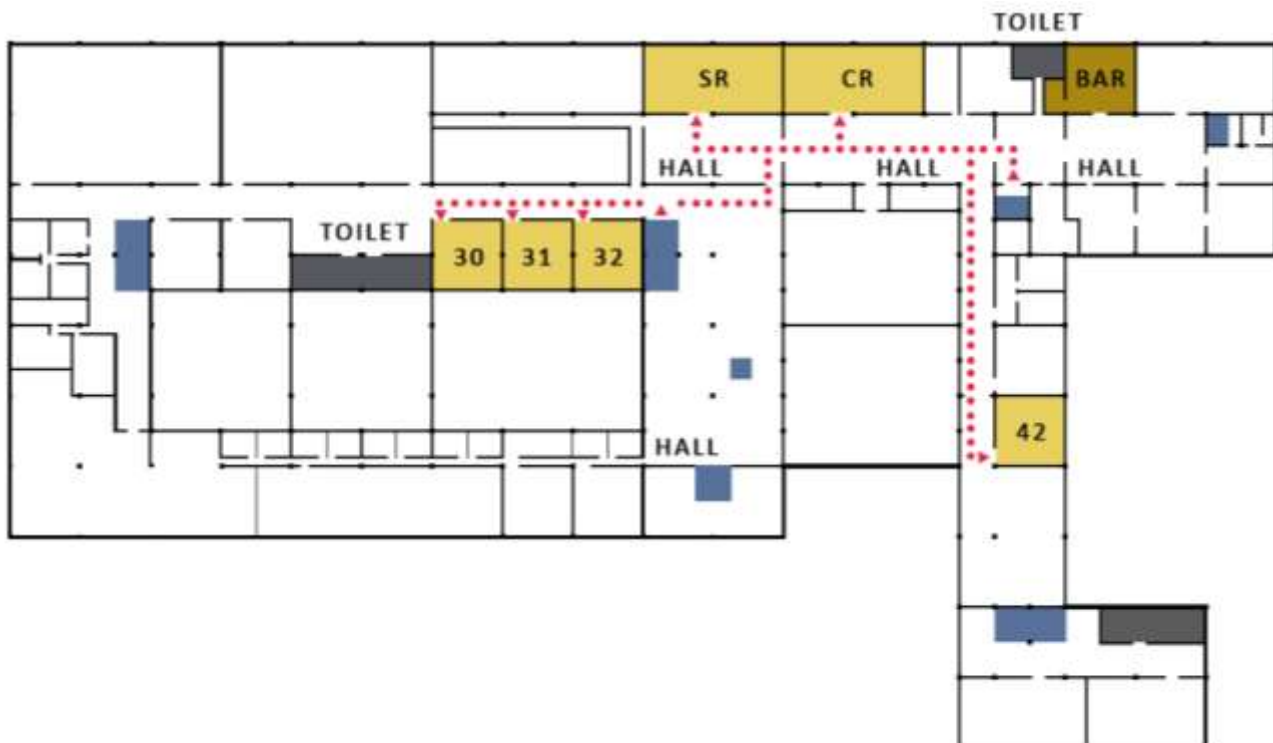



### Organizers



### Supporting Institutions



European  
Investment  
Bank



POLITÉCNICA



### Collaborating Institutions



NECTAR website: <http://www.nectar-eu.eu/>